

COMAV'S SLIDE GATE VALVE SGM is designed to shut off the material from hopper, silo, rotary valve when maintenance of downstream equipment is request.

SGM finds a wide application thank to a narrow profile and with the concept of "self-cleaning" on blade after each open stroke assures a long life.



APPLICATIONS

GRAVIMETRIC FLOW
POWDER
GRANULE
PELLETS

DESIGN

SIZE: DN 150, DN 200, DN 250
BODY: CASTING ALUMINIUM
BLADE: STAINLESS STEEL AISI 304/316L
OPERATION: MANUAL

FEATURES

PRESSURE: ATM
TEMPERATURE: MAX 100 °C
NARROW PROFILE
FREE OPENING
HORIZONTAL AND VERTICAL INSTALLATION
LONG LIFE

OPTIONALS

SPECIAL EXECUTION
FOR ABRASIVE PRODUCT
FOOD GRADE APPROVED MATERIAL
CUSTOM SIZE

BROCHURE



COMPLIANCE



II 2/3DC T135*

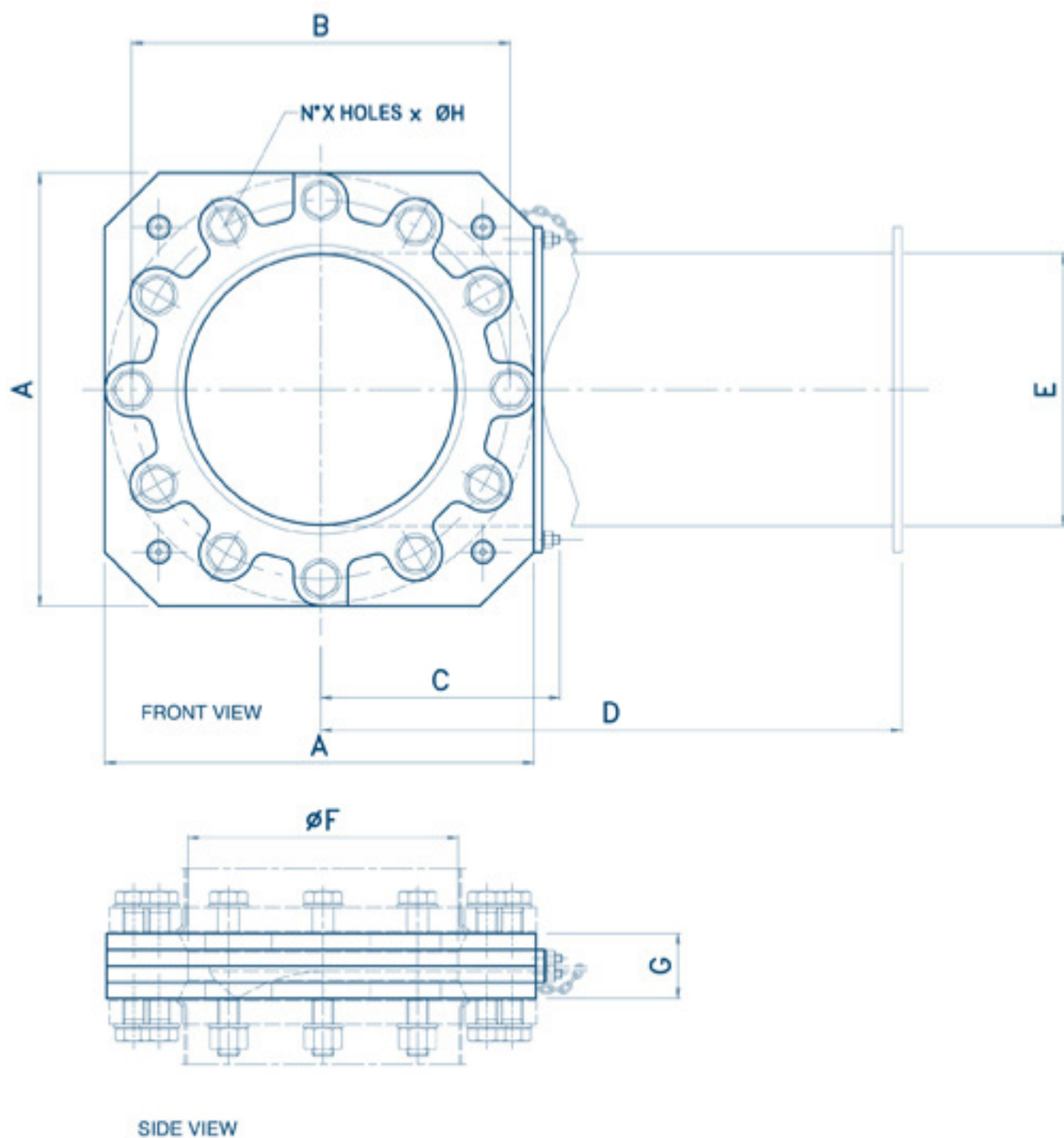

	A	B	C	D	E	F	G	I x ML
150	285	Ø240	180	406	160	Ø156	58	8 x Ø22
200	340	Ø295	208	484.5	205	Ø200	64	8 x Ø22
250	400	Ø350	237	568	264	Ø250	60	12 x Ø22