

Pneumatic connection drilled with M14 thread or 1/4" with Adapter

Threaded through-hole connections on TW-flanges

Durable light metal housing suitable for a wide range of applications

Flanges in media contact made of Cast iron or stainless steel

Wear-resistant sleeve with continuous fabric layer, also available in food-grade quality

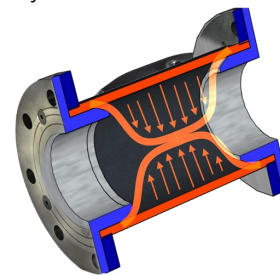
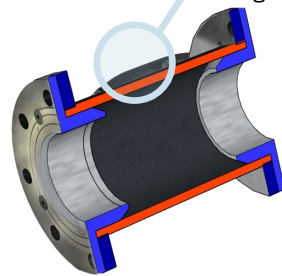

Simplicity in design and functional principle - the housing is pressurised compressing the flexible sleeve inside the housing and as such closing the valve. As the pressure inside the housing is released, the sleeve rebounds opening the valve.

Pinch Valves

Pneumatically Operated

Type

Pneumatically operated pinch valves are specially designed for use on silo vehicles as well as silo systems, pneumatic conveying systems and for processes with abrasive media in industrial plants.

PROKOSCH pinch valves are characterised by their robustness, the use of fewer individual parts and easy maintenance. The full bore of the pinch valve, minimizes flow resistance and wear on the sleeve.

The reinforced sleeve and flanges are the only wetted parts of the valve. The sleeve is wound with a continuous fabric layer to provide a long service life and improved wear resistance with high elasticity.

Technical Specifications

Diameters	DN80...DN100
Connections	Flange DIN EN 1092-1 (Model No. 500) TW-Flange DIN 28460 (Model No. 520)
Temperature range	0...+70°C
Pneumatic connection	M14, Optional 1/4"
Control media	Compressed air
Control pressure	up to 5-6 bar gage
Control valve	Optional, solenoid valve

Materials of Construction

Body	Aluminium alloy
Flanges	Cast iron, Optional stainless steel
Sleeve	NR, optional food grade quality

Features

Suitable as a shut-off valve for gaseous and liquid media. Suitable as a shut-off valve for solids and abrasive suspensions. Powder coating of exposed surfaces of the housing and flanges available as option. Other custom designs and features available on request.

Prokosch Pumpen und Armaturen

Prokosch Pumpen und Armaturen GmbH • In der Breitwiese 9 • 76684 Östringen • Deutschland
www.prokosch.de • sales@prokosch.de • Fon +49 (0)7259 9103 0 • Fax +49 (0)7259 9103 49



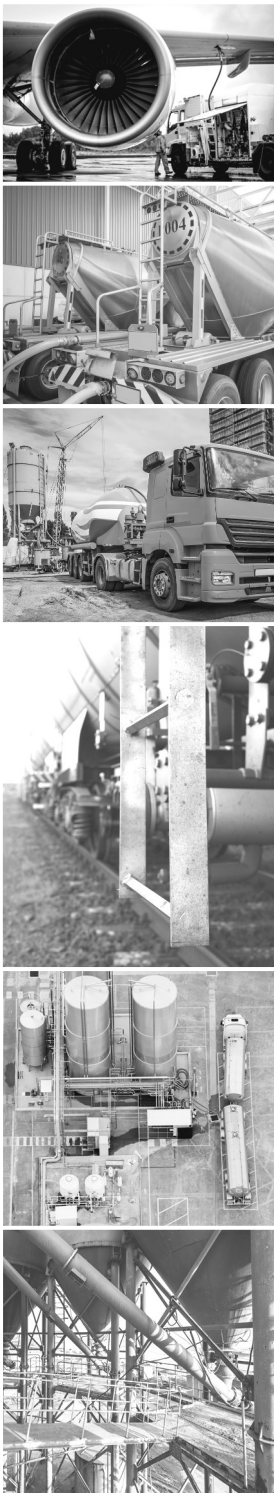

Nennweite Baureihe	Baumasse							Gewicht
	LW	L	D	K	d	i	H	
DN80 Model no. 500	78	228	200	160	18	8	81	6,1 kg
DN80 Model no. 520	78	280	154	130	M10	8	81	6,1 kg
DN100 Model no. 500	97	280	220	180	18	8	91	7,9 kg
DN100 Model no. 520	97	280	174	150	M12	8	91	7,2 kg

Pinch Valves

Sizing and Maintenance

Construction

The components of the pinch valve are as shown in the figure below: 1) the sleeve, 2) the flanges, 3) screws and, 4) the housing.

Each pinch valve is assembled and leak tested at the factory. The pinch valve housings have been subjected to a burst test at 24 bar.

The control valve used for the pinch valves is mostly a 3/2-way solenoid valve (not included as standard). Special control solutions are available on request.

Maintenance

Disassembling the pinch valve and replacing the sleeve is easy and does not require any special tools. The sleeve and flanges are available as spare parts. The screws are included with supply of the replacement flanges.

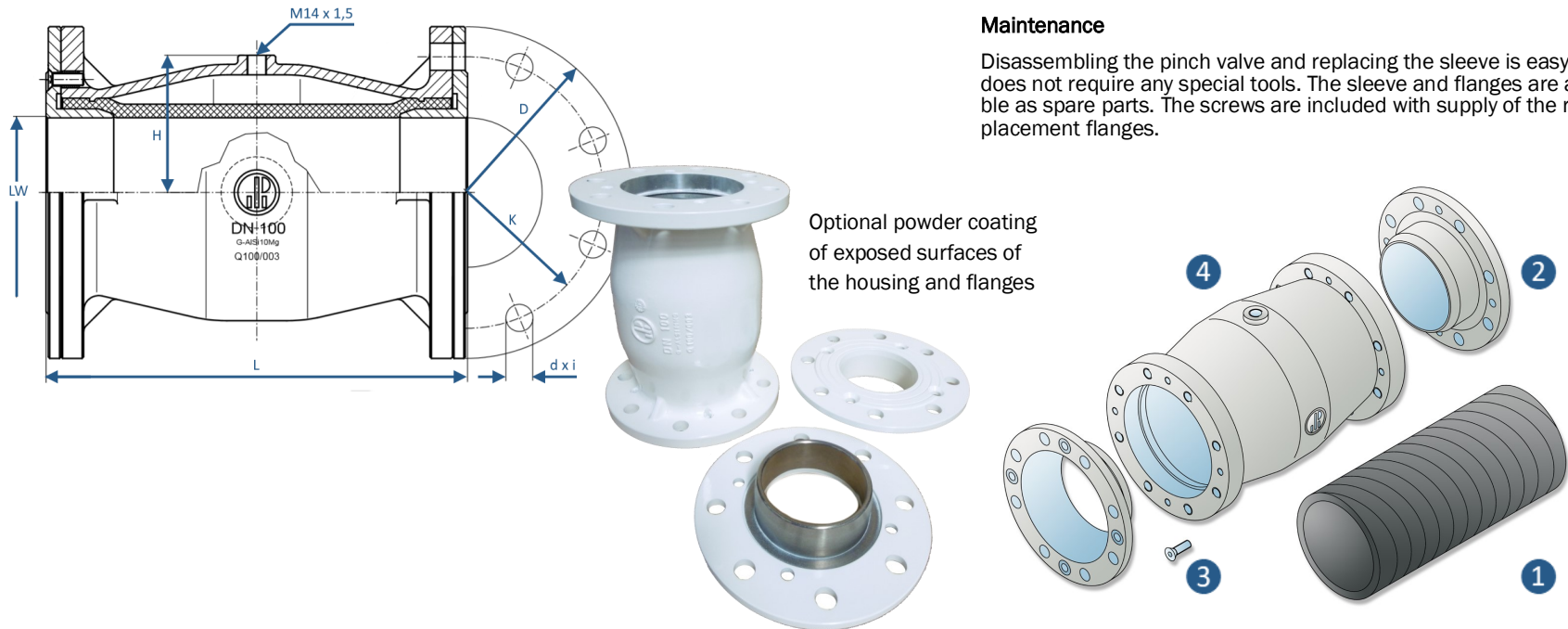

Prokosch Pumpen und Armaturen

Prokosch Pumpen und Armaturen GmbH • In der Breitwiese 9 • 76684 Östringen • Deutschland
 www.prokosch.de • sales@prokosch.de • Fon +49 (0)7259 9103 0 • Fax +49 (0)7259 9103 49

